

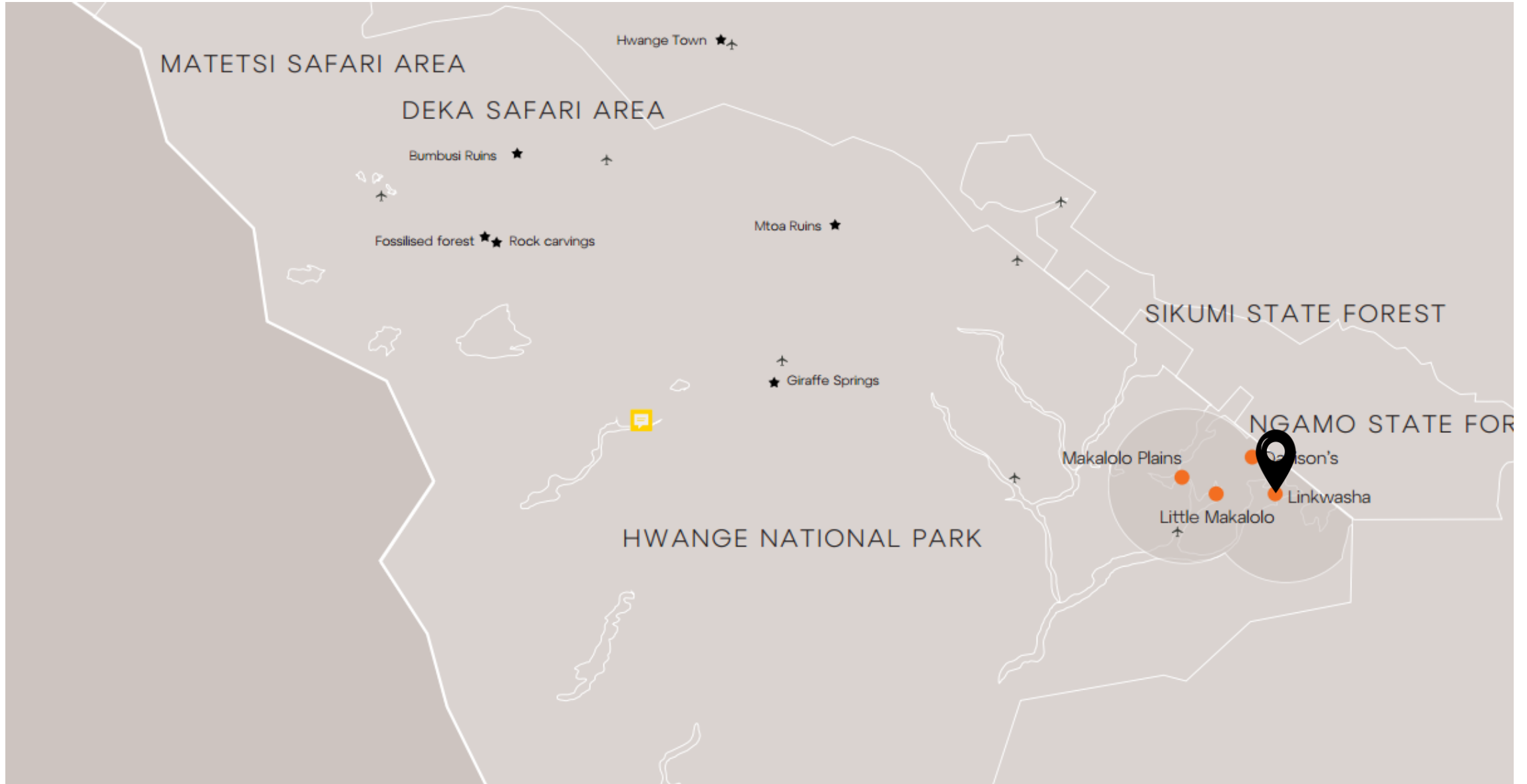

OL

WILDERNESS

LINKWASHA



UNIQUE SELLING POINTS

# Linkwasha

- Set on the edge of the famed Ngamo Plains, where large herds of plains game are regularly followed by their predators – including lions, cheetahs and African wild dogs – all year round
- Due to the ecological diversity (vast, open palm-fringed plains, grasslands, acacia woodlands and teak forests) and fertile ground in the south-eastern corner of Hwange, as well as year-round access to water, the area is a wildlife magnet
- In winter, the waterholes – including the one in front of camp – teem with elephants and buffalos
- Access to the abundant Linkwasha-Makalolo Private Wilderness Area means Wilderness guests have exclusive access to 34,000 hectares (84,000 acres) of land



# About Linkwasha



9 tents  
(1 family)



Star Bed



Cultural  
excursions



Game drives



Guided walks



Sunken hide

# Access to Linkwasha

- Airstrip name: Linkwasha Airstrip
- Duration to camp: An approximately 50- to 60-minute vehicle transfer





LINKWASHA PURPOSE

# Impact across generations

Alongside our non-profit Children in the Wilderness, Linkwasha works closely with surrounding communities and schools to ensure that they benefit from conservation and sustainable tourism.

## ACCOMMODATION

# An authentically African atmosphere

- The camp's nine expansive tented suites (including a family unit) each look out onto the camp's waterhole, and beyond onto a vast plain.
- An eclectic mix of contemporary interiors and Ndebele culture creates the convivial main area, where multi-level decks lead down to the camp's pool, a place to cool off in the midday heat. The water is also often enjoyed by the local elephants.



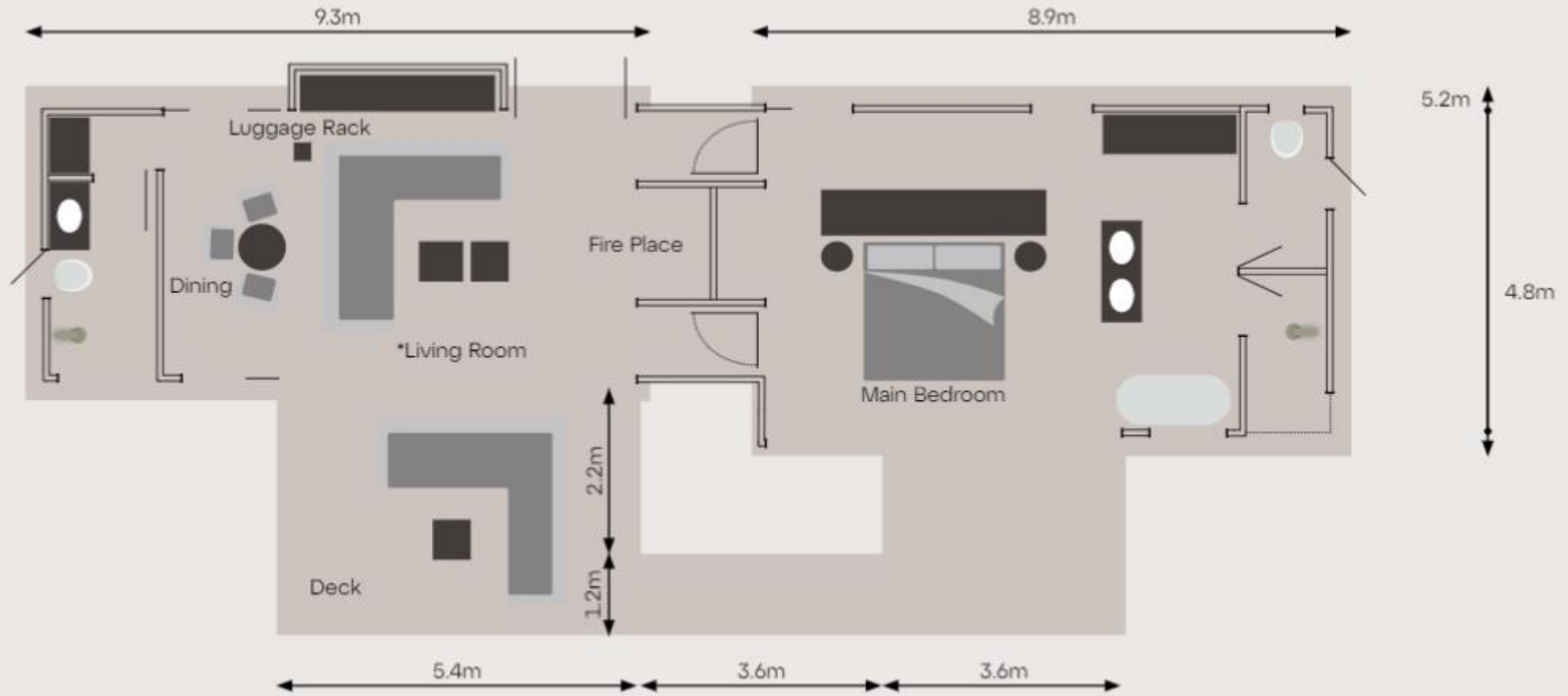

\*Living Room can be converted into Second Bedroom

Forward Facing

CAMP LAYOUT

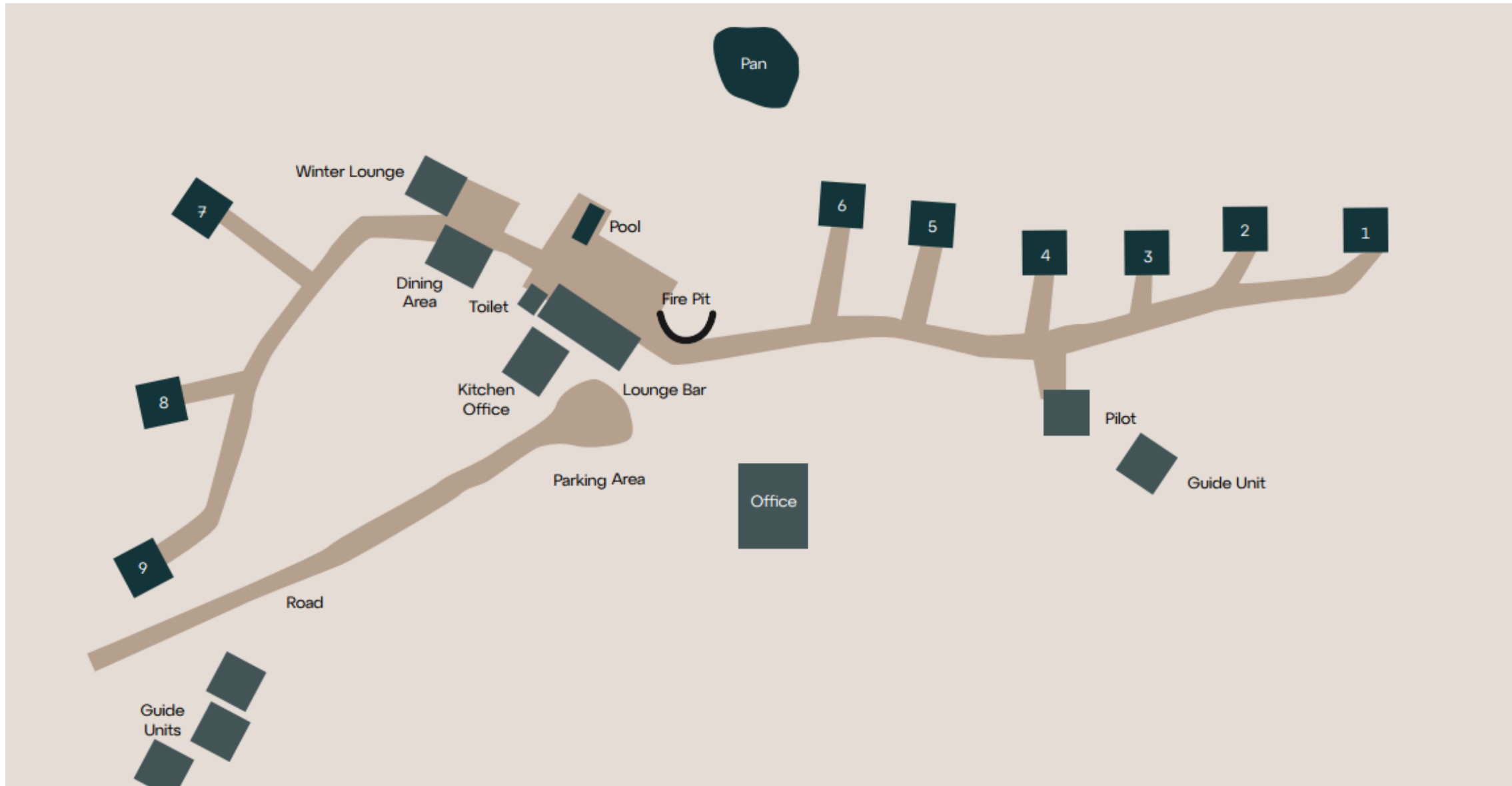

“Everything. These last 3 days have been a dream come true. We felt so welcomed and valued as guests and comfortable in our surroundings. The staff spoiled us, our guide educated and entertained us and the chef filled us with such delicious meals and snacks. I have never had such a fabulous trip, truly. This was the most unique and incredible experience I have ever had. I am still in awe regarding all of it. It's been a dream come true and I am sad to be leaving. Everyone here is so very kind and friendly and cheerful. I am grateful to you all and I will never forget my time here.

*Linkwasha Guest*

BUFFALO IN FRONT OF CAMP





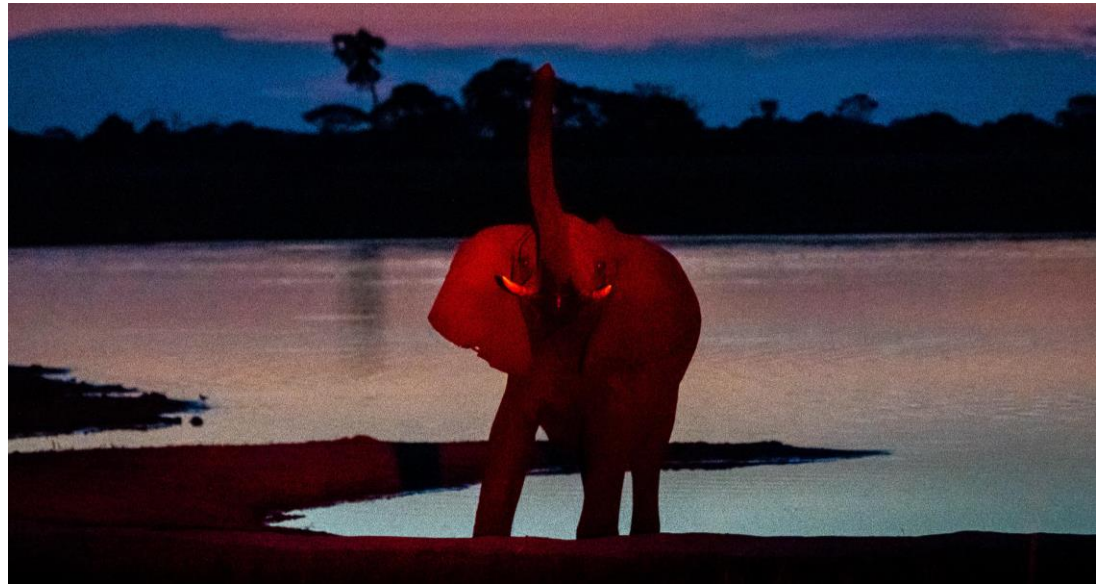









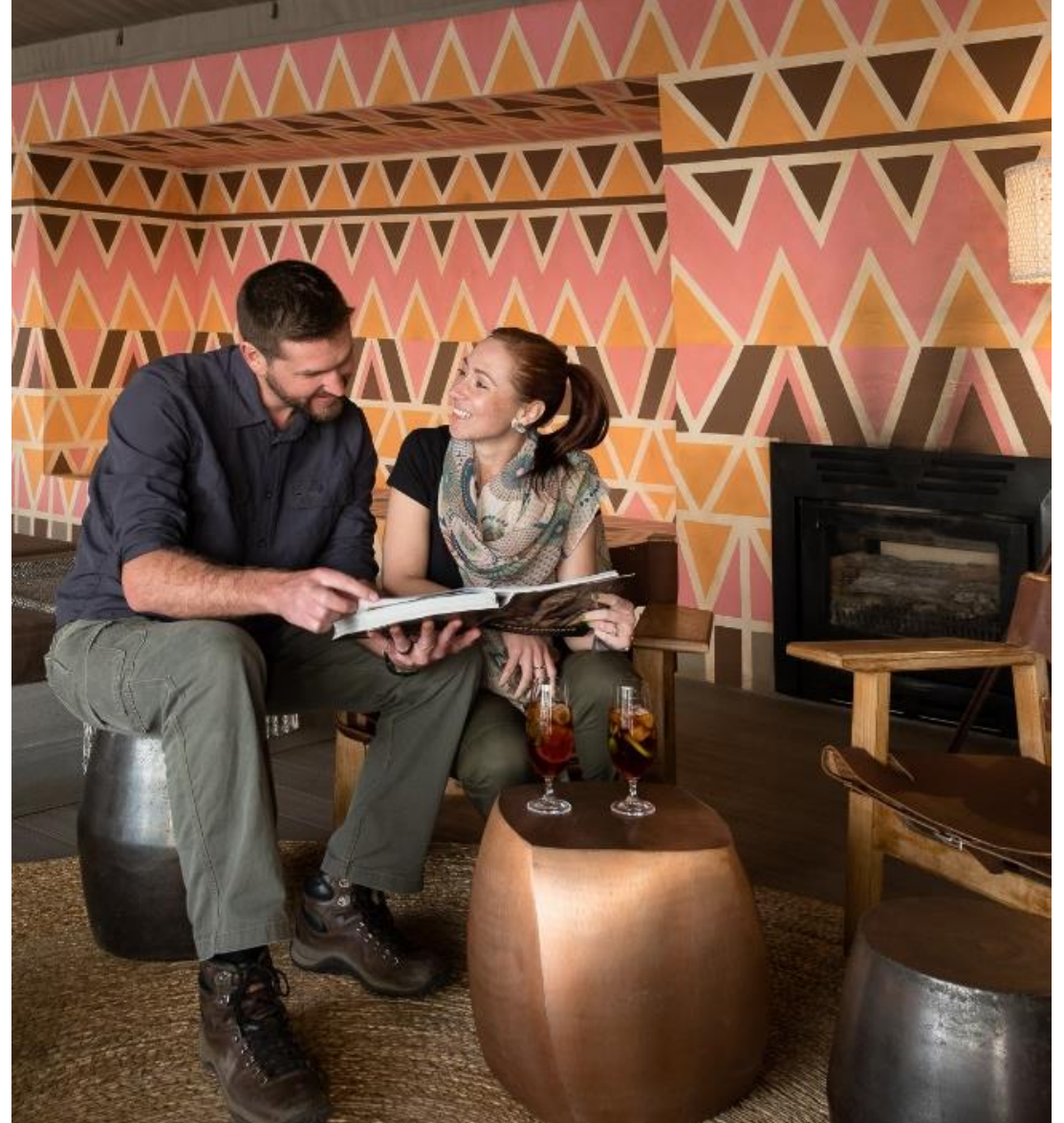

MAIN LOUNGE



BREAKFAST ON THE MAIN DECK



DINING COMPANIONS



CAMP FIRE PIT



MAIN POOL

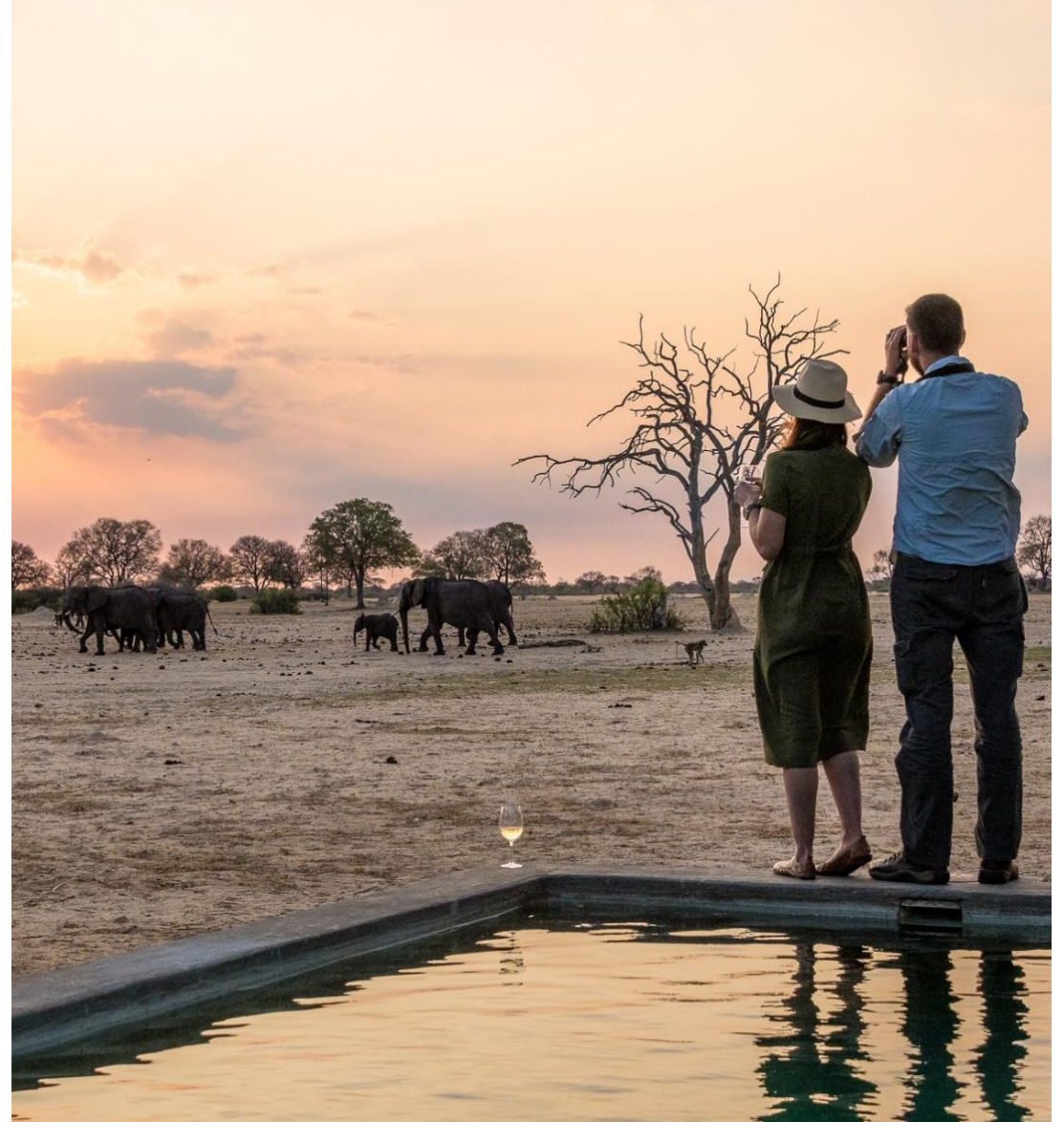

MAIN POOL VIEW

THE STAR BED AT SCOTT'S PAN



STAR BED





GUEST SUITE BEDROOM

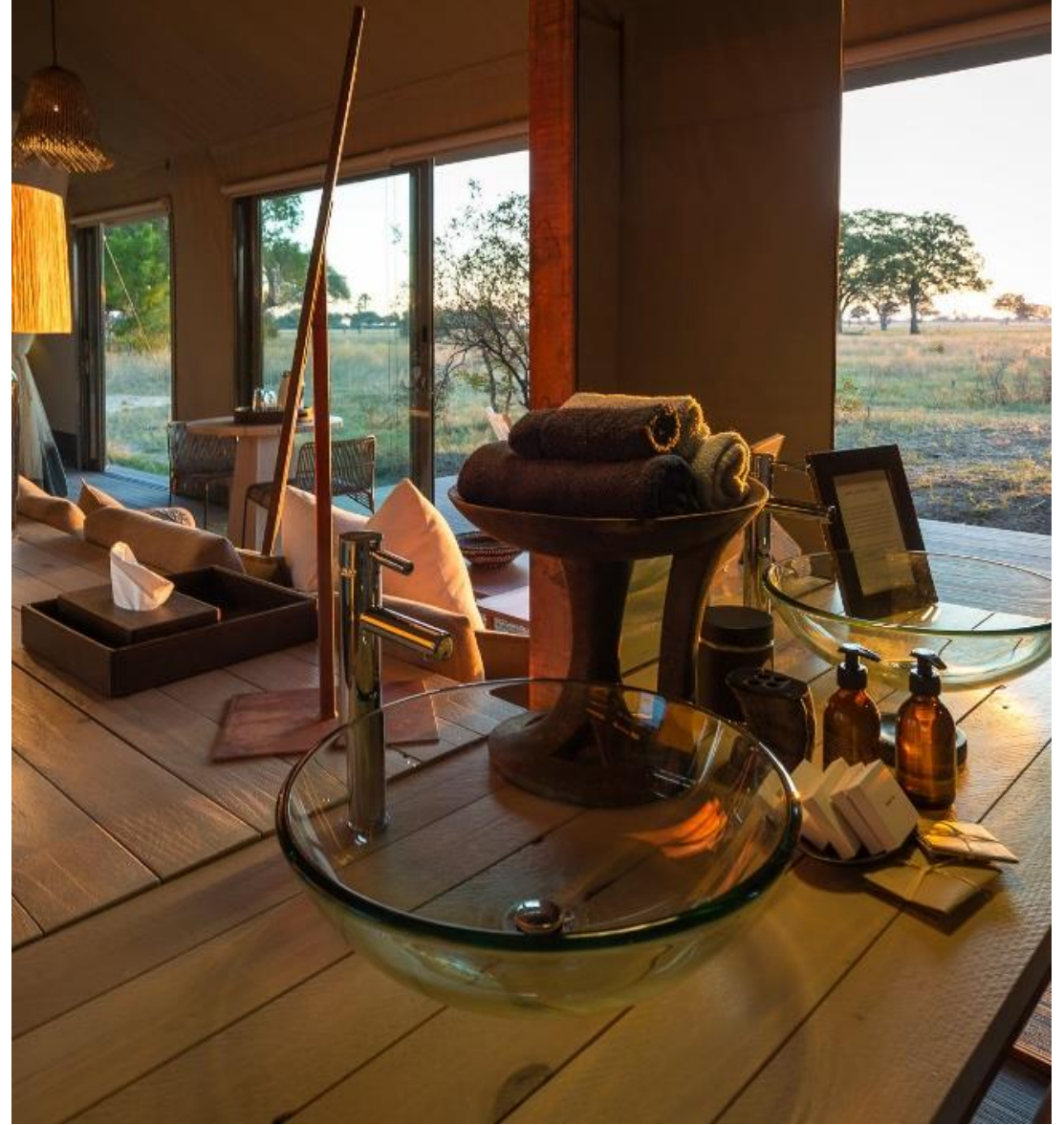
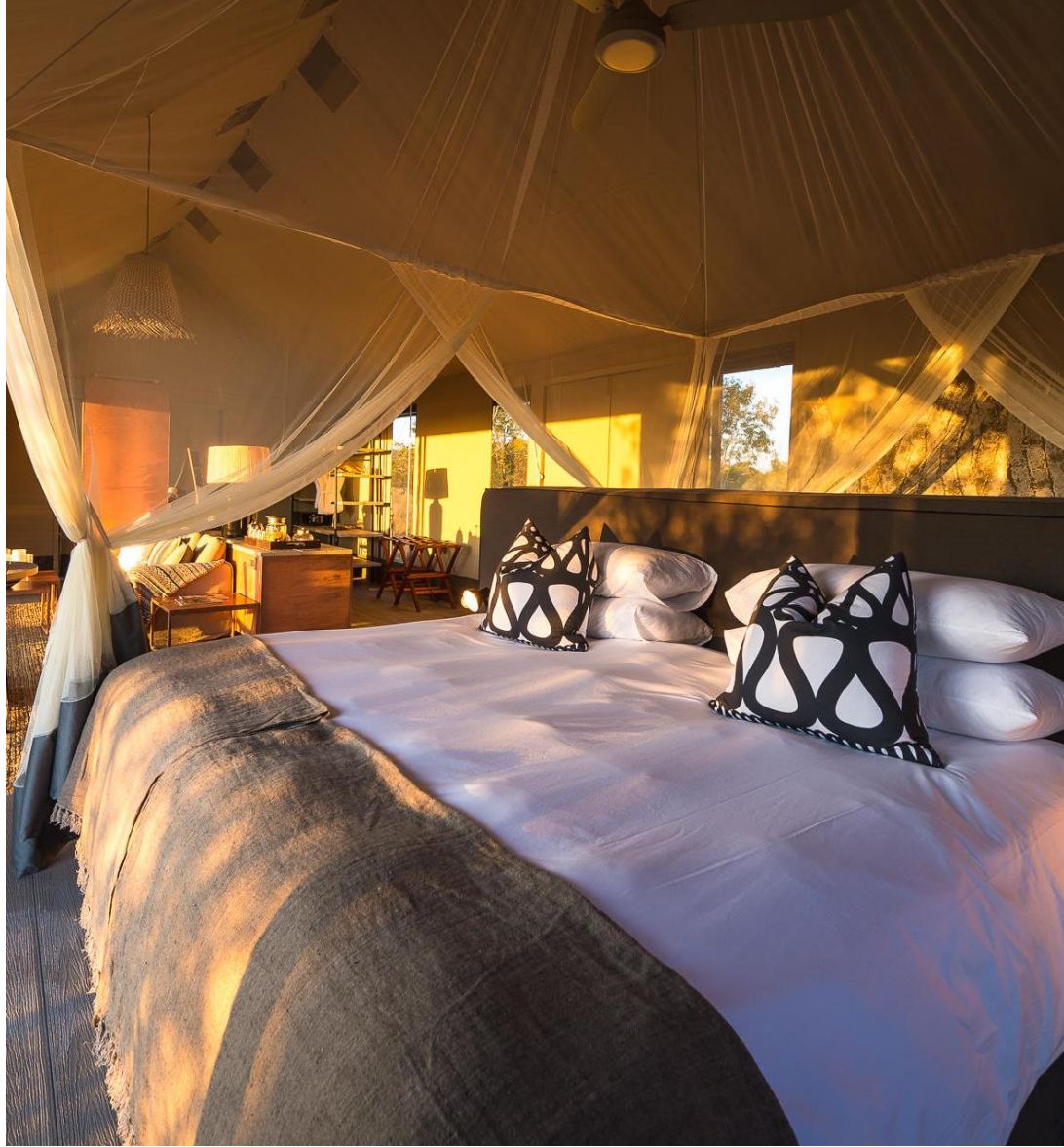

BATHROOM

# THANK YOU



WILDERNESS